

Laurel Promenade

SEC Laurel Canyon Blvd & Ventura Blvd, Studio City, CA



Project Features

- ◆ 2 Lease Opportunities (food uses allowed):
 - ◆ Ground Floor - 5,630 SF endcap
 - ◆ Second Floor - 3,269 SF in-line
- ◆ Asking Rents: \$48.00-\$84.00 PSF/Year
NNN = \$24.00 PSF/Year
- ◆ Traffic Counts: Ventura Blvd – 29,300 CPD
Laurel Canyon Blvd – 30,500 CPD

Demographics

(2024 Estimates)	1 Mile	3 Mile	5 Mile
Population	21,659	195,844	599,739
Avg. HH Income	\$240,850	\$171,379	\$156,577
Daytime Population	11,141	77,631	310,148



Kieran Sheridan

CA Lic. #02108499

ksheridan@clovercompany.com

Patrick Gilhooly

CA Lic. #01210372

pgilhooly@clovercompany.com



8675 Washington Blvd, Suite 201

Culver City, CA 90232

Phone: (310) 815-8611

www.clovercompany.com

**Laurel Center Group
California, LP**

Laurel Promenade

SEC Laurel Canyon Blvd & Ventura Blvd, Studio City, CA

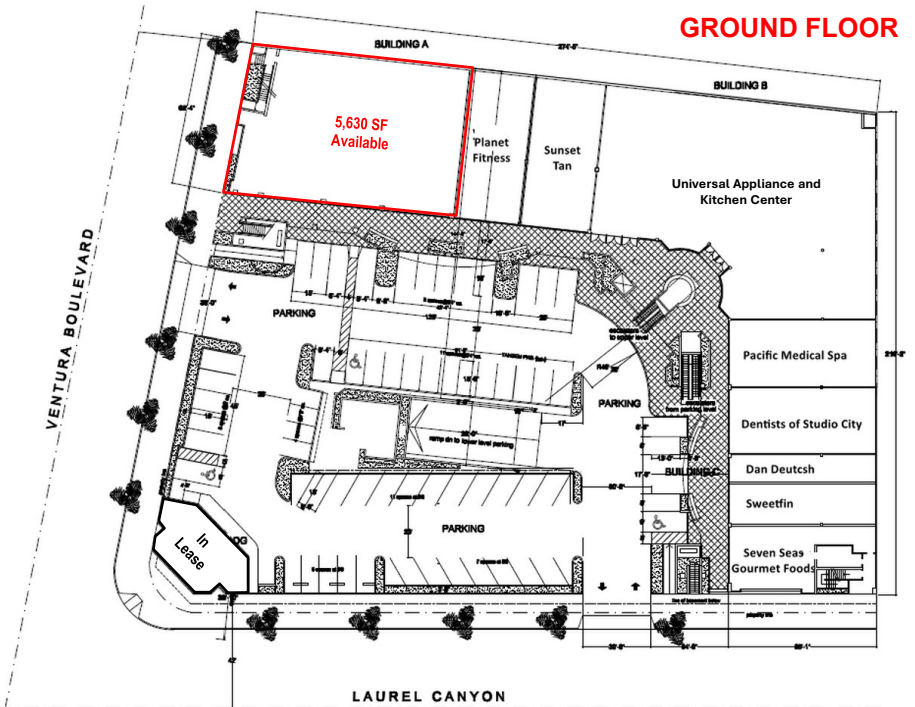
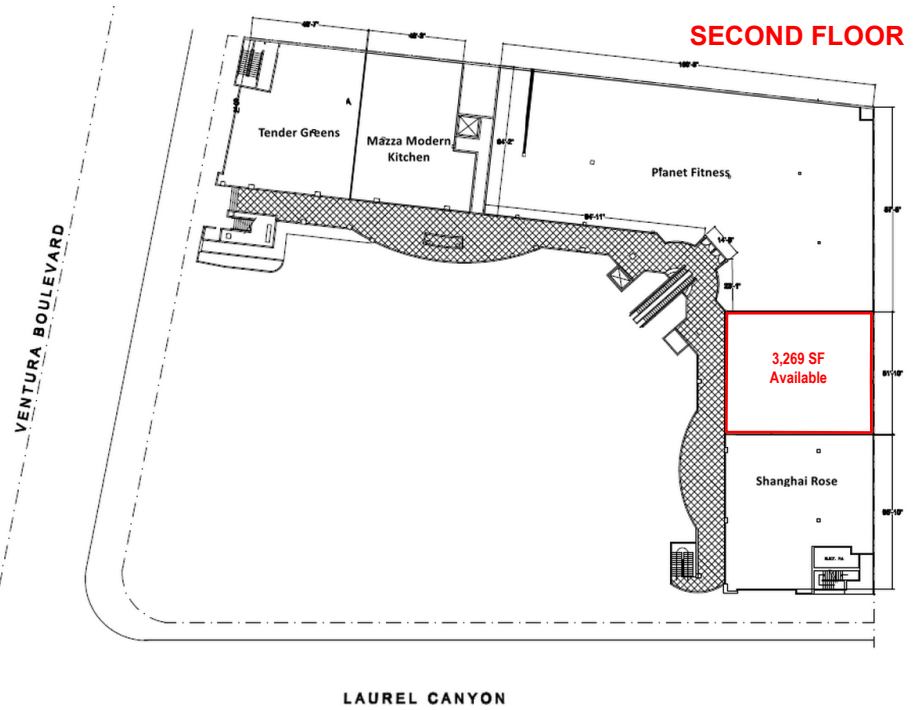

Kieran Sheridan

CA Lic. #02108499

ksheridan@clovercompany.com

Patrick Gilhooly

CA Lic. #01210372

pgilhooly@clovercompany.com

THE
CLOVER
COMPANY

Retail Real Estate Services

8675 Washington Blvd, Suite 201

Culver City, CA 90232

Phone: (310) 815-8611

www.clovercompany.com

Laurel Center Group
California, LP

The information contained herein has been obtained from sources we deem reliable. While we have no reason to doubt its accuracy, we do not guarantee it. All measurements and other facts shown are approximate, and should be independently verified by you and may not be relied upon as a precise representation by this office.